

RP-MF1200

Light Source

Light Source is a handy tool and instrument that provides you with several different wavelengths to test the fiber equipment in the optical network and FTTx construction. Light Source is ideal for field-test and laboratory test of communication at 850 nm, and datacom testing at 1310 nm/1550nm. Light Source features zero warm up, superb productivity and is easy to use with a pocket-size , rugged and handy design.

With LC patch cord, Light Source can be used for all of the most widespread fiber interfaces such as LC connector. It is suitable for testing both Single-mode and Multimode cables.



Feature

- Pocket-size & rugged & handy design
- Needless to pre-warm-up time
- Interchangeable SFP Module design with LC or SC connector
- Flexible to change any wavelength
- High stability of the Output Power
- Excellent & stable output wavelength
- Excellent re-connection repeatability
- Low Voltage Battery warning signal in LED
- Compatible to LC Connectors
- Economic type and easy to use
- Operates in CW (Continuous Wave) or Pulse Mode 270 Hz / 2 KHz
- The dust-proof design keeps fiber connectors clean
- Two AAA-size alkaline batteries
- LED indicator for Power, Battery Low indicators

Specification

| | |
|-------------------------------------|---|
| Laser Class | • Class 1 |
| Wavelength | • Base on Pluggable Light Source SFP module |
| Mode | • CW/Pulse Mode 270 Hz / 2 Khz |
| Battery | • AAA 1.5V X 2 |
| LED Indicator | • Power On (GREEN) / Battery Low (RED) |
| Output Power Accuracy | • +/- 0.2 dB |
| Output Power Stability (1HR) | • +/- 0.05 dB |
| Environment | • Operating temperature : 0°C to 50°C |
| Dimension | • 132.5 * 33.5 * 24.5 mm |
| Certification | • FCC, CE |

Application

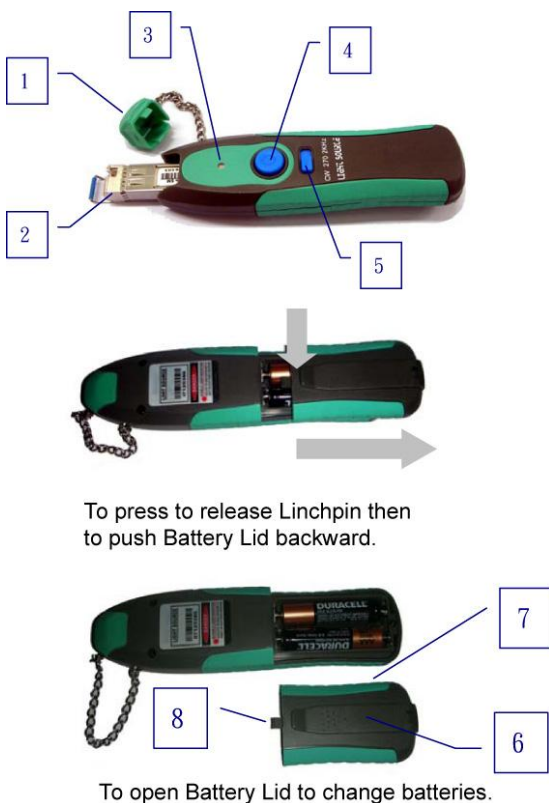

- Dust Cap** : prevent dirt contaminates the LD .
- SFP Module** : Interchangeable single LC or SC connector hot swap SFP module for identical wavelength.
- LED Indicator** : Power On and In Operation indicator (GREEN) and Battery Low Warning indicator (RED) .
- Button** : pressing to Turn On / Turn Off the LD emitting. to lock the Battery Lid.
- Mode Switch** : to select CW Continuous Wave Mode / Pulse Mode 270 Hz / 2 KHz Switch.
- Pen Clip** : a design to fasten the tool while put inside pocket.
- Battery Lid** : to open to change batteries.
- Linchpin**: a mechanical design to lock the Battery Lid.

Ordering information

| | |
|---------------------|-------------------------------|
| RP-MF1200 | Light Source Main Frame |
| MOD-VC0850/x | VCSEL 850 nm plug-in module |
| MOD-LE1300/x | LED 1300 nm plug-in module |
| MOD-FP1310/x | FP LD 1310 nm plug-in module |
| MOD-FP1550/x | FP LD 1550 nm plug-in module |
| MOD-DF1310/x | DFB LD 1310 nm plug-in module |
| MOD-DF1550/x | DFB LD 1550 nm plug-in module |

X= LC , SC Connector

REPOTEC CO., LTD.

3F, No.258, Lian Cheng Rd., Chung Ho City, Taipei Hsien 235, TAIWAN
 TEL: 886-2-8227-1888 FAX: 886-2-8227-1818