



## RP-IPJ811-95W

### 95W Industrial Gigabit PoE+ Injector

The RP-IPJ811-95W a high power single port Industrial POE Injector provides PoE power budget up to 95W. The device supports 10/100/1000Mbps data transmission and is powered with 48-56 Volts DC.

RP-IPJ811-95W is well suited for applications in deploying IP surveillance, WiFi AP or LoRa and for a broad range of applications. It is being rigorously tested for your Security, Transportation and Telco application in climatically demanding environments with wide temperature range from -40 to 75°C. With IP30 industrial case protection, the device provides a high level of immunity against corrosion and electromagnetic interference. RP-IPJ811-95W also allows either DIN rail or wall mounting for efficient use of cabinet

### Features

- One port 10/100/1000 Base-T (Data) for connection to the Ethernet Switch
- One port 10/100/1000 Base-T PoE (Power/Data) for connection to the PoE device (PD)
- Built-in hardened POE Controller
- Built-in CPU for true 95W POE detection
- Deliver ultrahigh power up to 95Watts
- Support redundant power
- Reverse polarity protection
- Overload current protection
- IP30 Rugged Aluminum housing design
- Working in extreme environment -40 to +75°C

## Specifications

<b>Standards</b>	<ul style="list-style-type: none"> <li>• IEEE 802.3 10Base-T Ethernet</li> <li>• IEEE 802.3u 100Base-TX Fast Ethernet</li> <li>• IEEE 802.3ab 1000Base-T Gigabit Ethernet</li> </ul>
<b>Interface</b>	<ul style="list-style-type: none"> <li>• 1 x RJ-45 10/100/1000BaseT(X) Data</li> <li>• 1 x RJ-45 10/100/1000BaseT(X) PSE Output power</li> </ul>
<b>Network Cable</b>	<ul style="list-style-type: none"> <li>• UTP/STP above Cat.5e Cable, EIA/TIA-568 10-ohm (100m)</li> </ul>
<b>Protocol</b>	<ul style="list-style-type: none"> <li>• CSMA/CD</li> </ul>
<b>LED Indicators</b>	<ul style="list-style-type: none"> <li>• PW1 (Green): ON – Power is detected</li> <li>• PW2 (Green): ON – Power is detected</li> <li>• PoE: ON – 95W PSE is in active mode. OFF – PSE is in idle mode.</li> </ul>
<b>POE Pin Assignment</b>	<ul style="list-style-type: none"> <li>• Pin 1 (V+), 2 (V+), 3 (V-), 6 (V-)</li> <li>• Pin 4 (V+), 5 (V+), 7 (V-), 8 (V-)</li> </ul>
<b>Reverse polarity protection</b>	<ul style="list-style-type: none"> <li>• Present</li> </ul>
<b>Overload current protection</b>	<ul style="list-style-type: none"> <li>• Present</li> </ul>
<b>Power Consumption</b>	<ul style="list-style-type: none"> <li>• 1W@48 VDC full load, Without POE</li> </ul>
<b>Power Supply</b>	<ul style="list-style-type: none"> <li>• 2 Redundant power source</li> <li>• 48V-56V VDC Power Input</li> </ul>
<b>POE power</b>	<ul style="list-style-type: none"> <li>• Maximum POE power 95watts at 56VDC input</li> </ul>
<b>Removable Terminal Block</b>	<ul style="list-style-type: none"> <li>• Provide 4 pin terminal block</li> <li>• Wire range: 0.34mm<sup>2</sup> to 2.5mm<sup>2</sup></li> <li>• Solid wire (AWG):12-24/14-22</li> <li>• Stranded wire(AWG): 12-24/14-22</li> <li>• Torque:5lb-In/0.5Nm/0.56Nm</li> <li>• Wire Strip length: 7-8mm</li> </ul>
<b>Environment</b>	<ul style="list-style-type: none"> <li>• Operating temperature : -40°C~75°C</li> <li>• Storage temperature: -40°C ~85°C</li> <li>• Operating Humidity: 5% to 95% (Non-Condensing)</li> </ul>
<b>Dimension</b>	<ul style="list-style-type: none"> <li>• 103.5 x 32 x 81.5 mm (LxWxD)</li> </ul>
<b>Housing</b>	<ul style="list-style-type: none"> <li>• Rugged Aluminum, IP30 Protection</li> </ul>
<b>Installation</b>	<ul style="list-style-type: none"> <li>• DIN Rail and Wall Mount Design</li> </ul>
<b>EMC/EMS</b>	<ul style="list-style-type: none"> <li>• CE, FCC</li> </ul>
<b>EMI</b>	<ul style="list-style-type: none"> <li>• FCC Part 15 Subpart B Class A, CE EN 55022 Class A</li> </ul>
<b>Safety</b>	<ul style="list-style-type: none"> <li>• IEC EN60950-1</li> </ul>

## Application

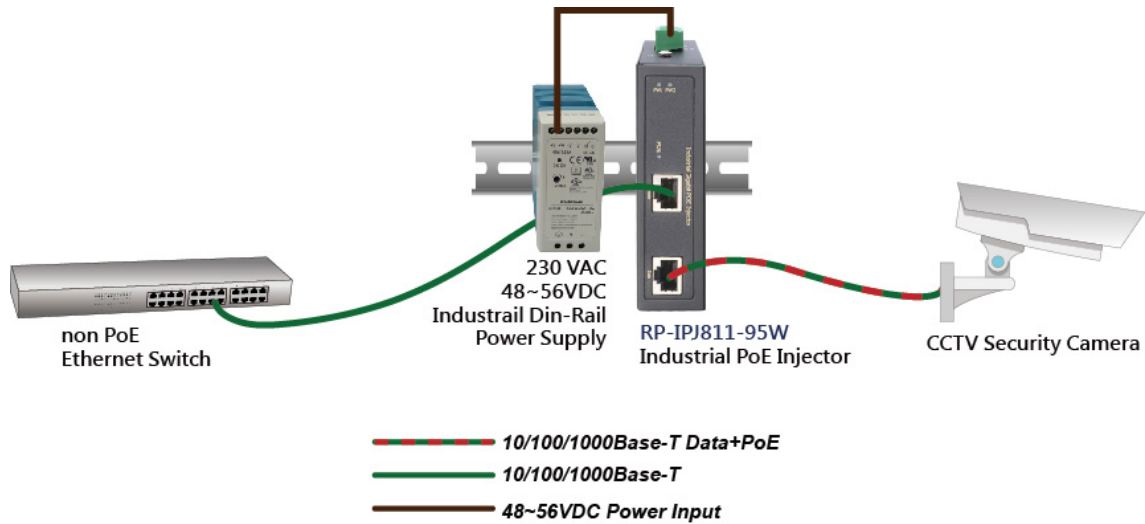

## Dimension

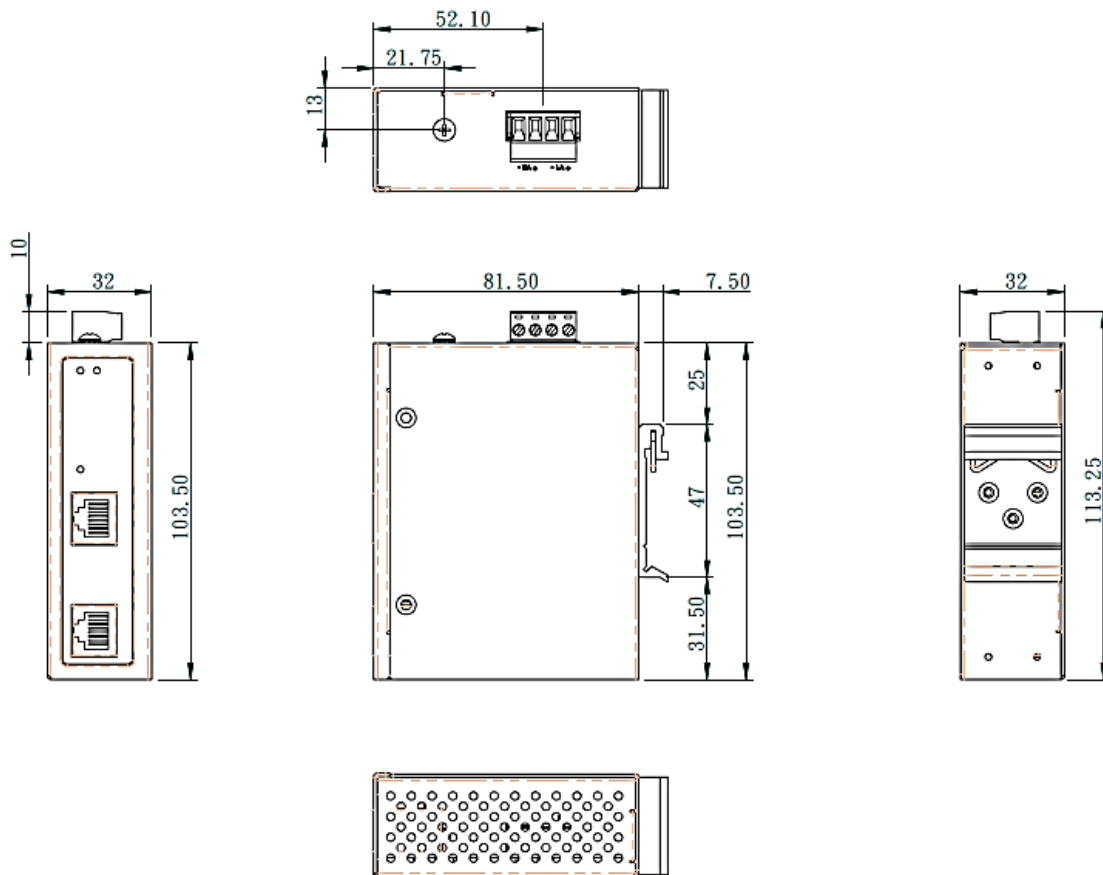

## Ordering information

**RP-IPJ811-95W** 95W Industrial Gigabit PoE+ Injector, 48-56VDC